

**Application for a premises licence to be granted
under the Licensing Act 2003**

PLEASE READ THE FOLLOWING INSTRUCTIONS FIRST

Before completing this form please read the guidance notes at the end of the form.
If you are completing this form by hand please write legibly in block capitals. In all cases ensure that your answers are inside the boxes and written in black ink. Use additional sheets if necessary.
You may wish to keep a copy of the completed form for your records.

We Marston's PLC apply for a premises licence under section 17 of the Licensing Act 2003 for the premises described in Part 1 below (the premises) and we are making this application to you as the relevant licensing authority in accordance with section 12 of the Licensing Act 2003

Part 1 – Premises details

Postal address of premises or, if none, Ordnance Survey map reference or description East Melksham (New Build), Cranesbill Road, Off Snowberry Lane,	
Post town East Melksham	Post code

Telephone number of premises (if any)	<input type="text"/>
Non-domestic rateable value of premises	£ <input type="text"/>

Part 2 - Applicant Details

Please state whether you are applying for a premises licence as

- | | | |
|---|-------------------------------------|-----------------------------|
| a) An individual or individuals* | <input type="checkbox"/> | please complete section (A) |
| b) a person other than an individual* | | |
| i. as a limited company | <input checked="" type="checkbox"/> | please complete section (B) |
| ii. as a partnership | <input type="checkbox"/> | please complete section (B) |
| iii. as an unincorporated association or | <input type="checkbox"/> | please complete section (B) |
| iv. other (for example a statutory corporation) | <input type="checkbox"/> | please complete section (B) |
| c) a recognised club | <input type="checkbox"/> | please complete section (B) |
| d) a charity | <input type="checkbox"/> | please complete section (B) |

- e) the proprietor of an educational establishment please complete section (B)
- f) a health service body please complete section (B)
- g) a person who is registered under Part 2 of the Care Standards Act 2000 (c14) in respect of an independent hospital please complete section (B)
- h) the chief officer of police of a police force in England and Wales please complete section (B)

* If you are applying as a person described in (a) or (b) please confirm:

Please tick ✓ yes

- I am carrying on or proposing to carry on a business which involves the use of the premises for licensable activities; or
- I am making the application pursuant to a
 - Statutory function or
 - A function discharged by virtue of Her Majesty's prerogative

(A) INDIVIDUAL APPLICANTS (fill in as applicable)

Mr Mrs Miss Ms Other title (For example, Rev)

Surname First names

I am 18 years old or over Please tick

Current postal address if different from premises address

Post Town Postcode

Daytime contact telephone number

Email address (optional)

Second Individual Applicant (if applicable)

Mr Mrs Miss Ms Other title (For example, Rev)

Surname First names

I am 18 years old or over Please tick

Current postal address if different from premises address

Post Town Postcode

Daytime contact telephone number

Email address (optional)

(B) OTHER APPLICANTS

Please provide name and registered address of applicant in full. Where appropriate please give any registered number. In case of a partnership or other joint nature (other than a body corporate), please give the name and address of each party concerned.

Name Marston's PLC
Address Marston's House, Brewery Road, Wolverhampton, WV1 4JT
Registered number (where applicable) 31461
Description of applicant (for example, partnership, company, unincorporated association etc.) Public Limited Company
Telephone number (if any) 01902 711300
E-mail address (optional)

Part 3 – Operating Schedule

When do you want the premises licence to start?

Day Month Year

0	1	0	6	2	0	1	4
---	---	---	---	---	---	---	---

If you wish the licence to be valid only for a limited period, when do you want it to end?

Day Month Year

--	--	--	--	--	--	--	--

If 5,000 or more people are expected to attend the premises at any one time, please state the number expected to attend.

N/A

Please give a general description of the premises (please read guidance note 1)

The applicant is proposing to construct licensed premises on Cranesbill Road, off Snowberry Lane, East Melksham which will form part of the East Melksham local development centre supporting the residential accommodation currently constructed and being constructed within the area of development. The premises will front on to the roundabout but be accessed from the adjacent side road providing access into the local commercial centre.

It is intended that the Applicant's premises will have in the order of 150 covers internally. The proposed premises will open as a public house providing a substantial quality food offering and limited regulated entertainment. The extent of the development is illustrated on the deposited plans along with the location of the site. Application will be made for a permit for AWP machines once the Licence is granted.

Application for Planning Permission has been submitted.

The premises has residential accommodation which includes the Manager's accommodation on the first floor.

The layout is proposed in accordance with the plans deposited with the Licensing Authority with this application, being: -

- Location plan - 3456/L100
- Site Plan - 3456/L104
- Ground floor licensing plan - 3456/L105 - forming the principal plan for licensing purposes showing both internal and external areas to be licensed.
- First floor licensing plan - drawing no. 3456/L106

All licensable activities are to take place internally in the area outlined in red. The licensable activities limited to sale by retail of alcohol, late night refreshment and recorded music only are proposed to be permitted to the external areas.

The premises seek to be able to sell to residents and supply their bona fide guests 24 hours per day, as per the non standard timing sought in accordance with the usual permission permitted historically.

The premises is to have the benefit of external areas which are identified on the ground floor plan and in particular comprise of two terraced areas, first to the front of the premises adjacent to the children's play area. It is envisaged that this area will be predominantly used by families being co-located next to the more family orientated dining area within the premises.

The second to the side of the premises which is adjacent to landscape garden area which will also have the benefit of additional seating, temporary structures providing shelter and shade and is anticipated to be utilised by more mature diners.

For the sake of simplicity the children's play area has been incorporated within the licensed area along with landscaped gardens. All external licensed areas are to have the benefit of waitress service (as appropriate) however the terraced areas will have a similar level of service to that provided internally.

On opening the premises will trade under one of the applicant's brands as a quality food lead outlet. There will be high levels of service and some waitress provision to the dining areas.

Other licensable activities, in particular regulated entertainment will be ancillary to the provision of food and alcohol. It is anticipated that any such regulated entertainment will be provided on an occasional basis only and limited to 12 occasions per year, although likely to be significantly less.

Appropriate noise attenuation measures are included within the structure of the new build and it is not anticipated that any issues will arise in relation to noise to local residents. The Operating Schedule has been completed on this basis.

The name of the premises will be provided in due course.

Consequently, the following permitted licensing hours for these premises would apply for on and off sales on opening are: -

Monday to Thursday 10:00 to 00:00
Friday / Saturday 10:00 to 01:00
Sunday 11:00 to 00:00

This application seeks to obtain authorisation under the Licensing Act 2003 for the following activities: -

- 1) To permit regulated entertainment comprising live music and amplified voice, recorded music by juke box and music systems, compares for functions and quizzes and similar forms of entertainment, indoor pub games comprising a sporting event in the presence of an audience, exhibition of a film principally video entertainment on screens and TV screens and amusement machines.

- 2) To permit sale of alcohol and such regulated entertainment until 01:00 the following morning on Friday, Saturday, Sunday and Monday at Bank Holiday weekends, Christmas Eve and Boxing Day.

New Years Eve to operate from 10:00 on the 31st December until 01:00 on the 2nd January, thereby providing extended hours.

Christmas Day to operate without a break in operational hours.

- 3) To permit the premises to open for licensable activities to show the broadcast of televised sporting events of national or international interest outside normal operating hours as identified in Box M such opening times for this purpose to be confirmed upon 7 days prior notice in writing to the Police before the premises intend to open, such notification to include the opening times and the sporting event which is to be shown.

- 4) To allow sale of alcohol and such regulated entertainment as follows: -
Mon/Tue/Wed/Thurs 10:00 – 00:00

Fri/Sat 10:00 – 01:00 following
Sun 11:00 – 00:00

- 5) To permit provision of refreshment after 23:00,

For customers hours of opening are from 07:00 through until 30 minutes after the cessation of licensable activities so as to facilitate the provision of breakfast.

What licensable activities do you intend to carry on from the premises?

(Please see sections 1 and 14 of the Licensing Act 2003 and Schedule 1 and 2 to the Licensing Act 2003)

Please tick ✓ yes

Provision of regulated entertainment

- a) Plays (if ticking yes, fill in box A)
- b) Films (if ticking yes, fill in box B)
- c) indoor sporting events (if ticking yes, fill in box C)
- d) boxing or wrestling entertainment (if ticking yes, fill in box D)
- e) live music (if ticking yes, fill in box E)
- f) recorded music (if ticking yes, fill in box F)
- g) performances of dance (if ticking yes, fill in box G)
- h) anything of a similar description to that falling within (e), (f) or (g) (if ticking yes, fill in box H)

Provision of late night refreshment (if ticking yes, fill in box I)

Supply of alcohol (if ticking yes, fill in box J)

In all cases complete boxes K, L and M

A

Plays Standard days and timings (please read guidance note 6)			Will the performance of a play take place indoors or outdoors or both – please tick {Y} (please read guidance note 2).	Indoors	
Day	Start	Finish		Outdoors	
Mon			Please give further details here (please read guidance note 3)	Both	
Tue					
Wed			State any seasonal variations for performing plays (please read guidance note 4)		
Thur					
Fri			Non standard timings. Where you intend to use the premises for the performance of plays at different times to those listed in the column on the left, please list (please read guidance note 5)		
Sat					
Sun					

B

Films Standard days and timings (please read guidance note 6)			Will the exhibition of films take place indoors or outdoors or both – please tick {Y}(please read guidance note 2).	Indoors	✓
Day	Start	Finish		Outdoors	
Mon	10:00	00:00	Please give further details here (please read guidance note 3) Exhibition of film principally video entertainment on screens and TV screens. There shall be no films show to a close seated audience.	Both	
Tue	10:00	00:00			
Wed	10:00	00:00	State any seasonal variations for the exhibition of films (please read guidance note 4)		
Thur	10:00	00:00		N/A – save as below	
Fri	10:00	01:00	Non standard timings. Where you intend to use the premises for the exhibition of films at different times to those listed in the column on the left, please list (please read guidance note 5)		
Sat	10:00	01:00			
Sun	11:00	00:00		When hours for sale of alcohol are extended hereunder these hours are also extended (see box J below)	

C

Indoor sporting events Standard days and timings (please read guidance note 6)			Please give further details (please read guidance note 3) As stated in Part 3 above and restricted to traditional pub games in the presence of an audience, including (but not limited to) darts, pool, snooker, dominos and similar
Day	Start	Finish	
Mon	10:00	00:00	State any seasonal variations for indoor sporting events (please read guidance note 4)
Tue	10:00	00:00	
Wed	10:00	00:00	N/A - save as below
Thur	10:00	00:00	Non standard timings. Where you intend to use the premises for indoor sporting events at different times to those listed in the column on the left, please list (please read guidance note 5)
Fri	10:00	01:00	
Sat	10:00	01:00	When hours for sale of alcohol are extended hereunder these hours are also extended (see box J below)
Sun	11:00	00:00	

D

Boxing or wrestling entertainment Standard days and timings (please read guidance note 6)			Will the boxing or wrestling entertainment take place indoors or outdoors or both - please tick {Y}(please read guidance note 2).	Indoors	
Day	Start	Finish		Outdoors	
Mon			Please give further details here (please read guidance note 3)	Both	
Tue					
Wed			State any seasonal variations for boxing or wrestling entertainment (please read guidance note 4)		
Thur					
Fri			Non standard timings. Where you intend to use the premises for boxing or wrestling entertainment at different times to those listed in the column on the left, please list (please read guidance note 5)		
Sat					
Sun					

E

Live music Standard days and timings (please read guidance note 6)			Will the performance of live music take place indoors or outdoors or both – please tick {Y} (please read guidance note 2).	Indoors	<input checked="" type="checkbox"/>
Day	Start	Finish		Outdoors	
Mon	10:00	00:00	Please give further details here (please read guidance note 3) Live music and amplified voice as stated in part 3 above. State any seasonal variations for the performance of live music (please read guidance note 4) N/A – save as below Non standard timings. Where you intend to use the premises for the performance of live music at different times to those listed in the column on the left, please list (please read guidance note 5) When hours for sale of alcohol are extended hereunder these hours are also extended (see box J below)	Both	
Tue	10:00	00:00			
Wed	10:00	00:00			
Thur	10:00	00:00			
Fri	10:00	01:00			
Sat	10:00	01:00			
Sun	11:00	00:00			

F

Recorded music Standard days and timings (please read guidance note 6)			Will the playing of recorded music take place indoors or outdoors or both – please tick {Y} (please read guidance note 2).	Indoors	
Day	Start	Finish		Outdoors	
Mon	10:00	00:00	Please give further details here (please read guidance note 3) Recorded music, including juke box, with or without a DJ, during normal business hours or as part of functions and including audience participation as specified in part 3 above. State any seasonal variations for playing recorded music (please read guidance note 4) N/A – save as below Non standard timings. Where you intend to use the premises for the playing of recorded music entertainment at different times to those listed in the column on the left, please list (please read guidance note 5) When hours for sale of alcohol are extended hereunder these hours are also extended (see box J below)	Both	<input checked="" type="checkbox"/>
Tue	10:00	00:00			
Wed	10:00	00:00			
Thur	10:00	00:00			
Fri	10:00	01:00			
Sat	10:00	01:00			
Sun	11:00	00:00			

G

Performances of dance Standard days and timings (please read guidance note 6)			Will the performance of dance take place indoors or outdoors or both – please tick {Y} (please read guidance note 2).	Indoors	✓
Day	Start	Finish		Outdoors	
Mon	10:00	00:00	Please give further details here (please read guidance note 3) As stated in Part 3 above	Both	
Tue	10:00	00:00			
Wed	10:00	00:00	State any seasonal variations for the performance of dance (please read guidance note 4) N/A – save as below		
Thur	10:00	00:00			
Fri	10:00	01:00	Non standard timings. Where you intend to use the premises for the performance of dance entertainment at different times to those listed in the column on the left, please list (please read guidance note 5) When hours for sale of alcohol are extended hereunder these hours are also extended (see box J below)		
Sat	10:00	01:00			
Sun	11:00	00:00			

H

Anything of a similar description to that falling within (e), (f) or (g) Standard days and timings (please read guidance note 6)			Please give a description of the type of entertainment you will be providing		
Day	Start	Finish	Will this entertainment take place indoors or outdoors or both – please tick {Y} (please read guidance note 2).	Indoors	
Mon				Please give further details here (please read guidance note 3)	Outdoors
Tue			Both		
Wed			State any seasonal variations for entertainment of a similar description to that falling within (e), (f) or (g) (please read guidance note 4)		
Thur					
Fri			Non standard timings. Where you intend to use the premises for the entertainment of similar description to that falling within (e), (f) or (g) at different times to those listed in the column on the left, please list (please read guidance note 5)		
Sat					
Sun					

I

Late night refreshment Standard days and timings (please read guidance note 6)			Will the provision of late night refreshment take place indoors or outdoors or both – please tick {Y} (please read guidance note 2).	Indoors	
Day	Start	Finish		Outdoors	
Mon	23:00	00:00	Please give further details here (please read guidance note 3) As stated in Part 3 above	Both	✓
Tue	23:00	00:00			
Wed	23:00	00:00	State any seasonal variations for the provision of late night refreshment (please read guidance note 4) N/A – save as below		
Thur	23:00	00:00			
Fri	23:00	01:00	Non standard timings. Where you intend to use the premises for the provision of late night refreshment at different times, to those listed in the column on the left, please list (please read guidance note 5) When hours for sale of alcohol are extended hereunder these hours are also extended (see box J below)		
Sat	23:00	01:00			
Sun	23:00	00:00			

J

Supply of alcohol Standard days and timings (please read guidance note 6)			Will the supply of alcohol be for consumption (Please tick box Y) (please read guidance note 7)	On the premises	
Day	Start	Finish		Off the premises	
Mon	10:00	00:00	State any seasonal variations for the supply of alcohol (please read guidance note 4)	Both	✓
Tue	10:00	00:00			
Wed	10:00	00:00			
Thur	10:00	00:00	Non-standard timings. Where you intend to use the premises for the supply of alcohol at different times to those listed in the column on the left, please list (please read guidance note 5)		
Fri	10:00	01:00			
Sat	10:00	01:00	To permit sale of alcohol and such regulated entertainment as authorised hereunder until 01:00 on Friday, Saturday, Sunday and Monday at bank holiday weekends, Christmas Eve and Boxing Day,		
Sun	11:00	00:00	To permit the sale of alcohol and such regulated entertainment authorised hereunder on New Years Eve commencing 10:00 until 01:00 on the 2 nd January. To permit the premises to open for licensable activities to show the broadcast of televised sporting events of national or International interest outside normal operating hours such opening times for this purpose to be confirmed upon 7 days prior notice in writing to the Police before the premises intend to open, such notification to include the opening times and the sporting event which is to be shown. To permit retail sale of alcohol 24 hours per day to residents and their bona fide guests.		

<p>State the name and details of the individual whom you wish to specify on the licence as premises supervisor</p> <p>Name: Steven John Roberts Address: c/o Marston's House, Brewery Road, Wolverhampton Postcode: WV1 4JT</p>

Personal Licence number (if known): 1840/PERS/2013/020
Issuing licensing authority (if known): Wychavon Council

K

Please highlight any adult entertainment or services, activities, other entertainment or matters ancillary to the use of the premises that may give rise to concern in respect of children (please read guidance note 8)

NONE save for the presence of AWP machines already authorised the use of which is not permitted by persons under the age of 18

L

Hours premises are open to the public Standard days and timings (please read guidance note 6)			State any seasonal variation (please read guidance note 4) Please see box J above
Day	Start	Finish	Non standard timings. Where you intend to use the premises to be open to the public at different times from those listed in the column on the left, please list (please read guidance note 5) The premises will close 30 minutes after the end of the non-standard timings identified in box J above.
Mon	07:00	00:30	
Tue	07:00	00:30	
Wed	07:00	00:30	
Thur	07:00	00:30	
Fri	07:00	01:30	
Sat	07:00	01:30	
Sun	07:00	00:30	

M

Describe the steps you intend to take to promote the four licensing objectives:

a) General – all four licensing objectives (b,c,d,e) (please read guidance note 9)

This is an application for a new Premises Licence to be constructed on land off Snowberry Lane which will be accessed via the commercial centre which will form part of the support and community basis for the new housing development in the surrounding area. The site is to be located adjacent to other commercial users with residential accommodation located to one side of the premises. The layout is particularised on the plans and has the benefit of substantial parking facilities and will offer food both internally and externally.

Marston's Plc have constructed many premises of this nature and on this occasion it is intended that the premises will operate under the brand of Two for One which will be supported by family friendly facilities including both internal and external play areas.

The above is provided by way of explanation and not intended to be converted into conditions.

b) The prevention of crime and disorder

The applicant has undertaken a risk assessment in connection with the operation of this unit taking into consideration the area in which it is located and their previous experience of units of this nature and their operation and impact on the immediate vicinity.

With regards to the prevention of crime and disorder the applicant would offer the following steps in order to address this issue: -

1. Alcoholic drinks may not be removed from the premises in open containers saved for consumption in external areas provided for that purpose.
2. No customers carrying opened bottles of alcoholic drink upon entry shall be admitted to premises at anytime the premises are open to the public.
3. It is considered that for the nature of the operation door supervisors will not be required however, the Designated Premises Supervisor will undertake a risk assessment should unusual events takes place and if they consider it appropriate will employ the same.
4. Any persons exerclsing security (as defined by paragraph 21a of schedule 2 of the Private Security Act 2001 shall be licensed by the Security Industry Authority).
5. Such person will be employed at the premises at the discretion of the designated premises supervisor/holder of the premises licence.
6. Internal CCTV to cover bar servery and main point of access and egress, such images to be retained for a period of 30 days and be available to the Police and Licensing Officer on their reasonable request.

c) Public safety

The applicant has undertaken a risk assessment with regard to public safety.

As this is a New Build all equipment will be to the latest standard and will be British Standard approved.

The applicant will ensure that fixtures and fittings provided to the premises will be of an appropriate nature.

The applicant undertakes to comply with reasonable requirements of the Building Control Officer. In any event, the approval of these statutory authorities will be required before the premises can open to the public.

Proposed condition :-

1. The Premises Licensee will comply with the reasonable requirements of the Fire Officer from time to time

d) The prevention of public nuisance

The applicant has undertaken a risk assessment with regards to public nuisance.

The applicant proposes conditions as follows: -

1. Where appropriate prominent and legible notices shall be displayed at all exists requesting the public to respect the needs of the local residents and to leave the premises and area quietly.
2. The doors and windows to the premises are to be double glazed.

e) The protection of children from harm

The restrictions set out in the Licensing Act 2003 will apply. No unusual or additional risk of harm to children have been identified.

1. No films or videos of any description will be shown so that they can be viewed by persons under the age of any applicable BBFC/Local Authority certification.
2. Children under the age of 16 shall not be permitted to enter or remain at the premises after 22:00 unless resident, dining with an adult or attending a pre booked function.

Please tick ✓ Yes

- I have made or enclosed payment of the fee
- I have enclosed the plan of the premises
- I have sent copies of this application and the plan to responsible authorities and others where applicable
- I have enclosed the consent form completed by the individual I wish to be premises supervisor, if applicable

I understand that I must now advertise my application

I understand that if I do not comply with the above requirements my application will be rejected

IT IS AN OFFENCE, LIABLE ON CONVICTION TO A FINE UP TO LEVEL 5 ON THE STANDARD SCALE, UNDER SECTION 158 OF THE LICENSING ACT 2003 TO MAKE A FALSE STATEMENT IN OR IN CONNECTION WITH THIS APPLICATION

Part 4 – Signatures (please read guidance note 10)

Signature of applicant or applicant’s solicitor or other duly authorised agent. (Please read guidance note 11). **If signing on behalf of the applicant please state in what capacity.**

Signature: John Gaunt & Partners.....

Date: 25 March 2014.....

Capacity: Solicitors.....

For joint applications signature of 2nd applicant or 2nd applicant’s solicitor or other authorised agent. (Please read guidance note 12). **If signing on behalf of the applicant please state in what capacity.**

Signature: John Gaunt & Partners.....

Date:

Capacity: Solicitors.....

Contact name (where not previously given) and address for correspondence associated with this application (please read guidance note 13) John Gaunt & Partners Omega Court 372 Cemetery Road	
Post town Sheffield	Post code S11 8FT

Schedule 11

Consent of individual to being specified as premises supervisor

I, Steven John Roberts
of Marston's House, Brewery Road, Wolverhampton, WV1 4JT.....

hereby confirm that I give my consent to be specified as the designated premises
supervisor in relation to the application for grant of the premises licence by

..... MARSTON'S PLC
{names(s) of premises licensee}

relating to a premises licence for

..... EAST MELKSHAM CRANESBILL ROAD off SNOWBERRY LANE
{name and address of premises to which the application relates}

and any premises licence to be granted in respect of this application made by

..... MARSTON'S PLC
{name(s) of premises licensee}

concerning the supply of alcohol at

..... EAST MELKSHAM NO. 3 BUILD. CRANESBILL ROAD
..... off SNOWBERRY LANE
.....

{name(s) and address of premises to which application relates}.

I also confirm that I currently hold a personal licence.

Personal Licence number: 1840\PERS\2013\020

Personal Licence issuing authority: Wychavon District Council

Signed:..... 

Name (please print): STEVEN JOHN ROBERTS.....

Dated: 28/2/14

The drawing is the copyright of Axiom Architects.
 It is to be used only for the purposes for which it was prepared. It is not to be used for any other purpose without the written consent of Axiom Architects. Axiom Architects is not responsible for any errors or omissions in this drawing or for any consequences arising therefrom.

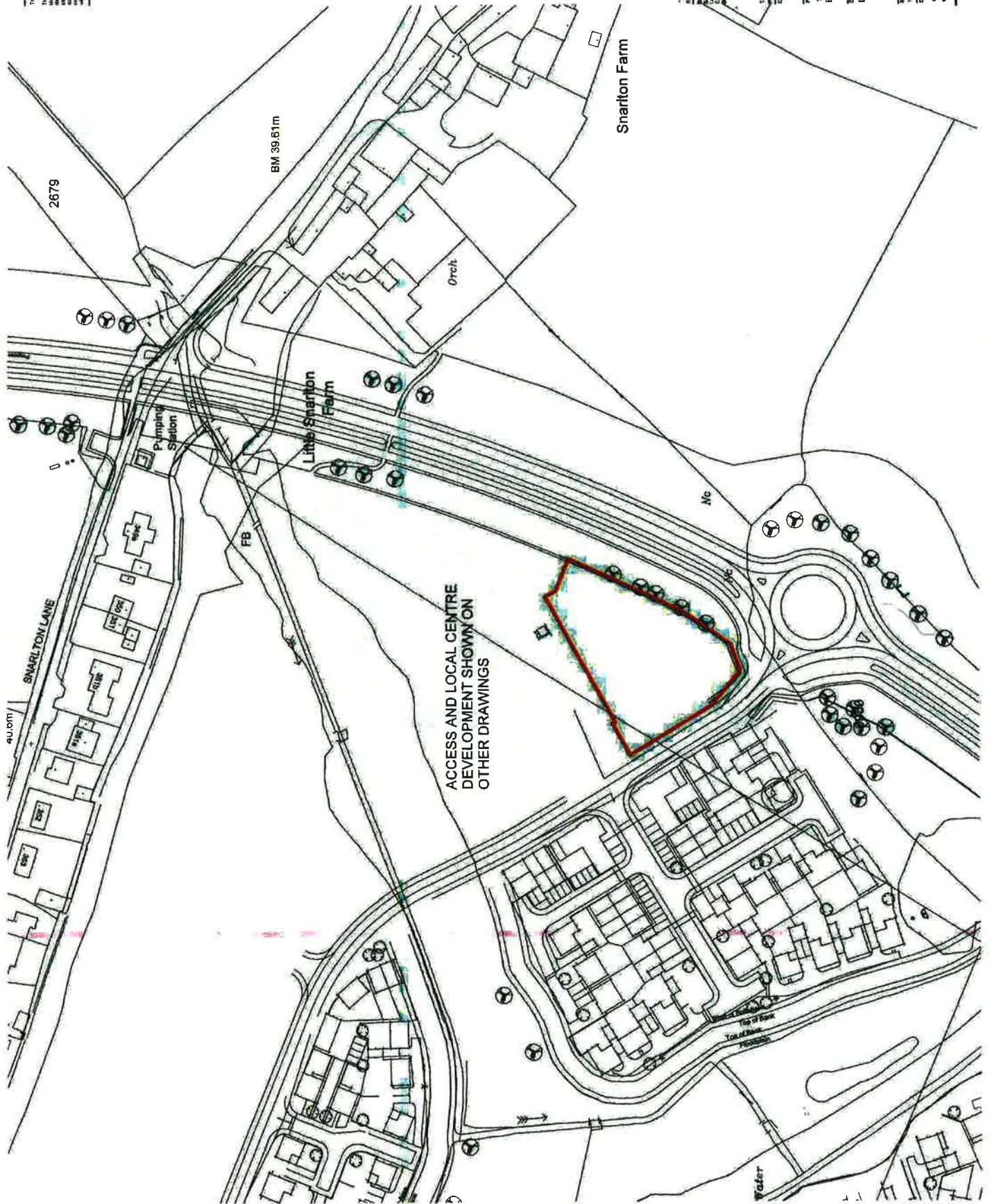

AXIOM ARCHITECTS	No. 1072, KILNDRY EAST MEIKSPAN TEL: 01273 42026 WWW.AXIOMARCHITECTS.CO.UK
150 COVER PUB RESTAURANT EAST MEIKSPAN	LOCATION PLAN
1:100 @ A1 Drawing No.	3456/L/100

The planning is the responsibility of Axiom Architects.
 This plan is for information only. It is not to be used for any other purpose.
 It is not to be used for any other purpose.
 It is not to be used for any other purpose.

1:500 Scale
 1:100 Scale
 1:50 Scale

AXIOM ARCHITECTS
 150 COVER PUB RESTAURANT
 EAST MELKSHAM

**150 COVER PUB RESTAURANT
 EAST MELKSHAM**

3456/L104

